

# BRO-WP-A

## Brono - Adjustable Wallpack Series

The Brono wall pack series is a contemporary, commercial-grade area luminaire. The adjustable LED wall pack light allows you to adjust the head of the fixture up to almost 90 degrees. Typical applications include pedestrian walkways, building entrances, multi-use facilities, industrial facilities, perimeter parking areas, storage facilities, institutions, schools, and loading docks



### Applications:

- Exterior building
- Tunnel
- Walkway
- Wall
- Entryway

# BRONO Series



## Specifications

Model	HYP-CN-0030	HYP-CN-0040	HYP-CN-0060	HYP-CN-0080
Lumen Output	3000 lm	4320 lm	7200 lm	9600 lm
Wattage	25 W	36 ‡	60 ‡	80 ‡
Voltage	AC100 - 277V	AC100 - 277V	AC100 - 277V	AC100 - 277V
Dimensions	168X199X107 mm	168X199X107 mm	242X288X160 mm	242X288X160 mm
Available Color Temp.	4000K, 5000K, 6000K	4000K, 5000K, 6000K	4000K, 5000K, 6000K	4000K, 5000K, 6000K
L70	≥50,000 hours	≥50,000 hours	≥50,000 hours	≥50,000 hours
Weight	2.2 kg	2.2 kg	4.00 kg	4.00 kg
Warranty	5 years	5 years	5 years	5 years
Rating	IP65			
Application	Outdoor			
Installation	Wall Mount/ Surface Mount			

## Dimensions

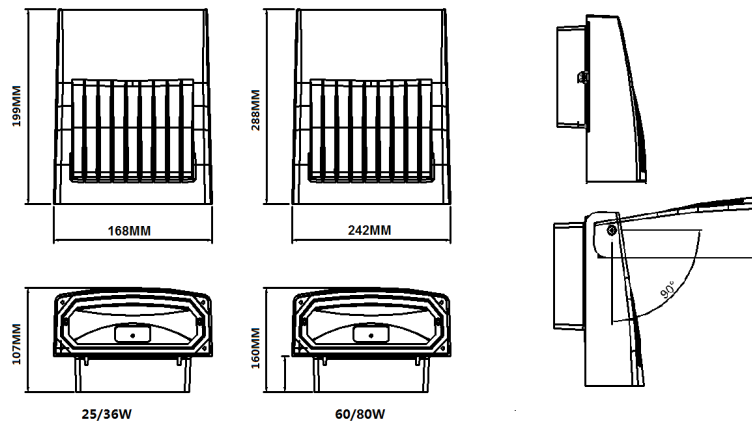

NOTES: Specifications and dimensions are subject to change without notice.  
Visit us at [www.solidiumtech.com](http://www.solidiumtech.com)  
Office Telephone: 1.604.371.4112

Last Revised: 6/28/2016



# BRONO Series



## Installation

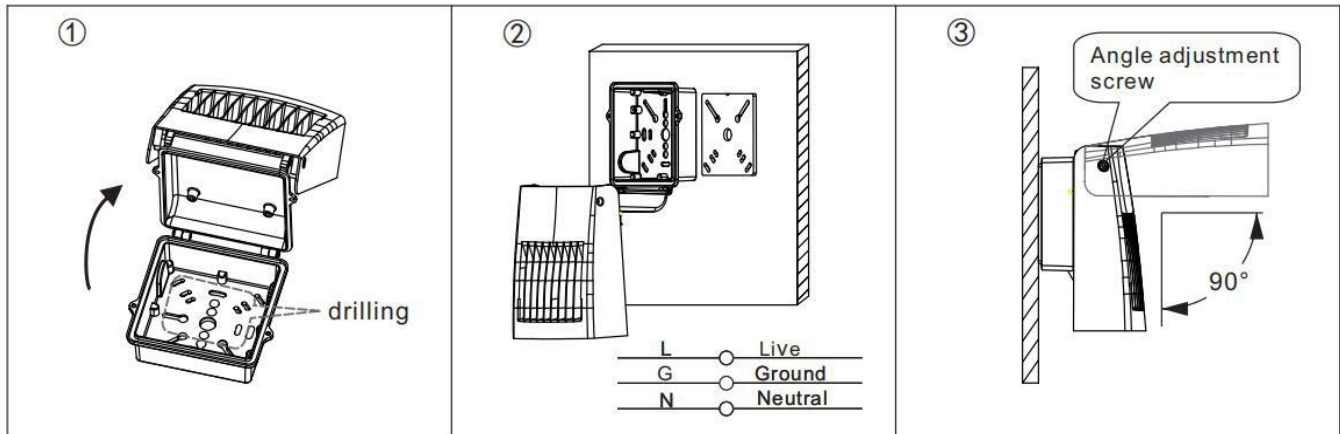

1. Disassemble the power supply box, drill 5 holes in the base area, support 3 1/4" and 4" junction box.
2. Mount the base of the power supply box on the wall and finish wiring (L for live, G/E for ground, N for neutral).
3. Close the power supply box and fix power supply box with screw.  
Please use angle adjustment screw to adjust the beam.

## Ordering Code

LAMP TYPE	LAMP CODE	POWER RATING	MAX INPUT VOLTAGE	CCT	CRI	[NULL]	INSTALL METHOD	LENS	[NULL]	[NULL]
HYP-A	WP	0030 0040 0060 0080	100-277V 347-480V	4K0 5K0 6K0	70	120	WM SF	CL FR	00	X