



Installation & Maintenance Manual

SLD-HM-XXXX & HELOS-PLUS-XXXX

IMPORTANT SAFETY INSTRUCTIONS *Mesures de Sécurité à Respecter*

This product must be installed in accordance with the applicable installation code by a person familiar with the construction and operation of the product and the hazards involved.

Ce produit doit être installé selon le code d'installation pertinent, par une personne qui connaît bien le produit et son fonctionnement ainsi que les risques inhérents.

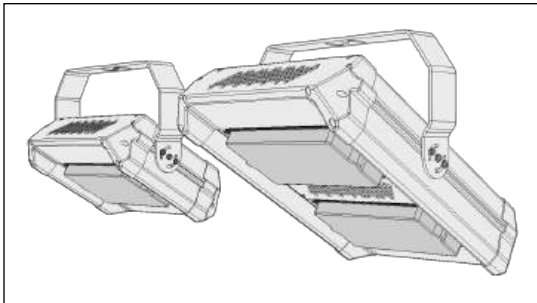

Brief Introduction

LED Pendant, Pole, and General High Mast Luminaire. Suitable for Wet Locations.

Surface/Pendant LED Luminaire—Certified to Canada/US Standards
CSA C22.2 No. 250.0
UL1598, 3rd Edition

Suitable for Wet Locations. *Convient aux emplacements mouillés.*

Install with minimum spacings of 30 cm (1 ft) between top of luminaire and the ceiling.
Installer avec des espacements minimum de 30 cm (1 FT) entre haut de luminaire au plafond.

Not suitable for ceiling mount application. *Ne convient pas aux applications de montage au plafond.*

Keep protective barrier in place. *Ne pas enlever l'écran protecteur.*

Mount this luminaire using only the mounting bracket supplied by the manufacturer or similar.
Mount ce luminaire utilisant uniquement le support de montage fourni par le fabricant ou similaire.

Twist-on wire connectors are not re-usable. Replace only with un-used weatherproof twist-on wire connectors. *Remplacer uniquement avec de nouveaux intempéries twist-on connecteurs de fils.*

Min 90°C supply conductors. *Les fils d'alimentation doivent convenir pour 90°C.*

Not for use in dwellings. *Ne pas utiliser dans les logements.*

5/10/2023

Basic Information (in millimeter)

Ventilating holes in the fixture are critical for proper fixture function. When installing, ensure proper positioning, orientation, and spacing of the fixture to any obstruction in the immediate environment.

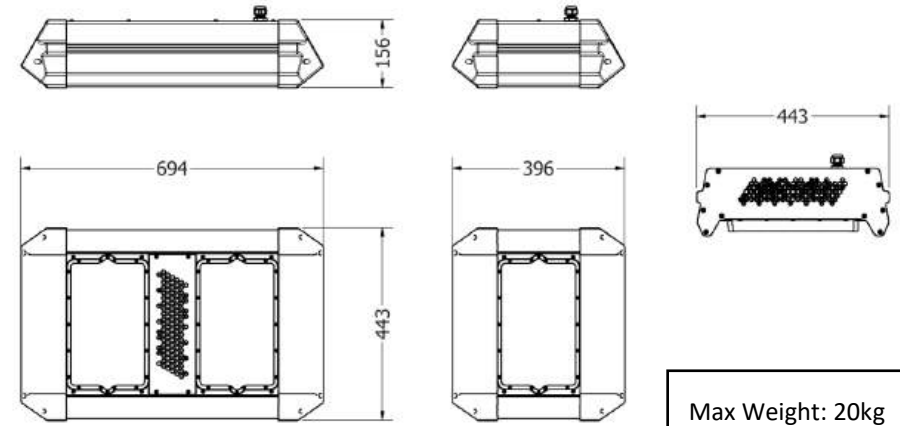

Wiring Instructions

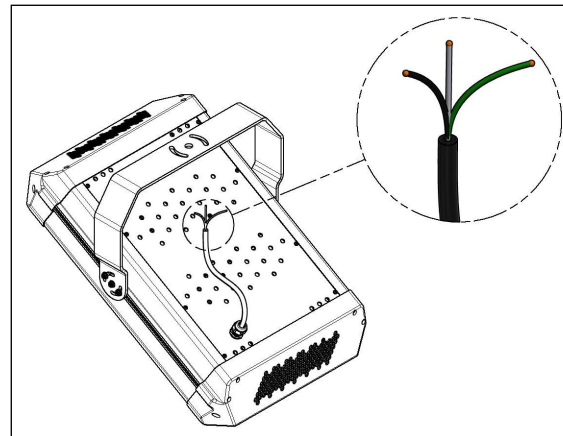

Wiring is to be terminated outside the enclosure from the supplied whip exiting the fixture.

Where applicable, ensure the enclosure of electrical components are properly grounded to earth ground.

Be aware of potential hazards when installing or servicing.

Power off AC main supply before installing or servicing.

Wiring from LED
Driver to AC Supply, or
LED Driver Terminal
Block Colouring

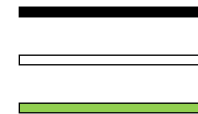

AC/Line 100/277/347/480V Supply Connection (Black)
AC/Neutral Connection (White)
Earth Ground Connection (Green)

Wiring for 0-10V
Dimming

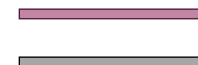

Dim + Connection (Violet, or as Labeled)
Dim - Connection (Grey, or as Labeled)

Pendant stem, chain, or hanger sets not included with fixture.

Pendant hanger shown is for representation only. Alternative, pendant kits can be used.

Supplied Hardware:

- Bracket with eyebolt
- (Optional) Galvanized aircraft cable with gripper*

For all other issues regarding installation of the suspension kit, please contact Lumigan Technologies.

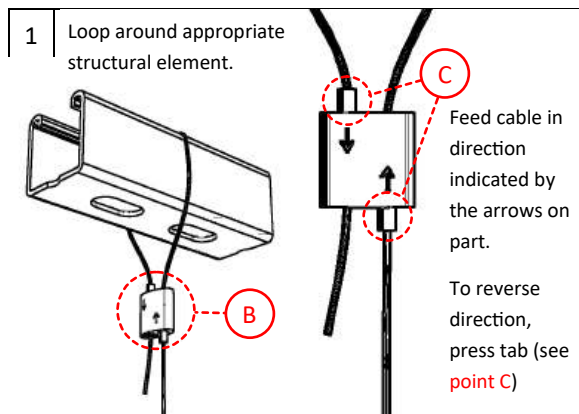

Bracket is secured in place on both sides of the fixture by **the supplied (6 sets) of 1/4"-20 bolts, nuts, and/or toothed washers** through the shown bracket holes and slots. If the nuts are of a serrated flange type, toothed washers are not necessary. The bolts are pre-assembled into the fixture.

Install the fixture to the bracket and orient accordingly, using the proper equipment to aim the fixture. Tighten the nuts to the appropriate torque to secure the fixture for its final installation.

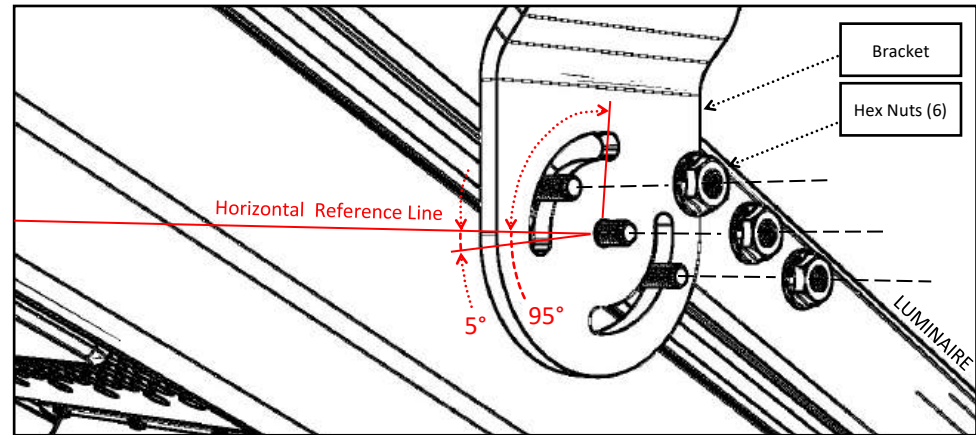

www.lumingen.com

Bracket Mounting Installation

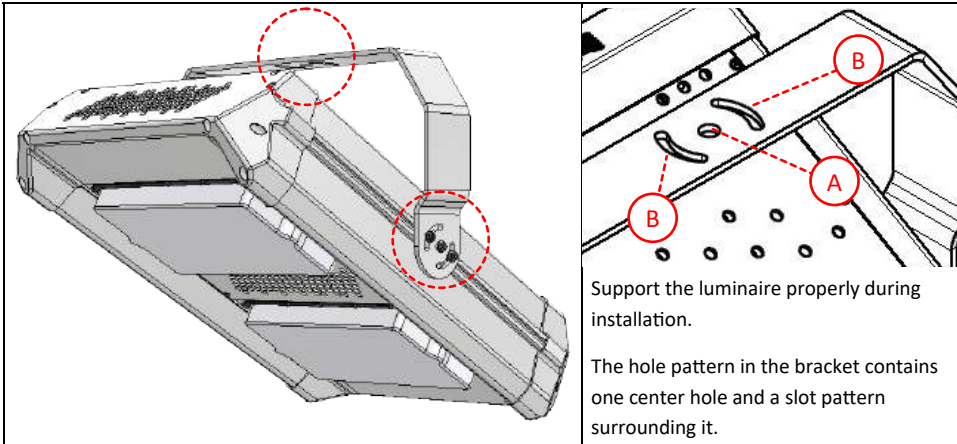

Proper installation:

The following bolts, nuts and washers are not provided with the fixture.

Install **one 5/8-in bolt and the respective nut and washers** (See **Point A**) through the center hole. Install **two 3/8-in bolts and the respective nuts and washers** (one set for each slot, see **Point B**).

The surface of the bracket near the bolt holes should be installed flush to installation surface.

Adjust for proper orientation of the bracket. Tighten all bolts to the appropriate torque for each bolt.

Safety cable may be installed with the fixture for additional installation security. Safety cable must be attached to the appropriate structure and slack must be removed from the safety cable for it to function properly.

Orienting the Tilt of the Fixture:

Bracket is secured in place on both sides of the fixture by **the supplied (6 sets) of 1/4"-20 bolts, nuts, and/or toothed washers** through the shown bracket holes and slots. If the nuts are of a serrated flange type, toothed washers are not necessary. The bolts are pre-assembled into the fixture.

Install the fixture to the bracket and orient accordingly, using the proper equipment to aim the fixture. Tighten the nuts to the appropriate torque to secure the fixture for its final installation.

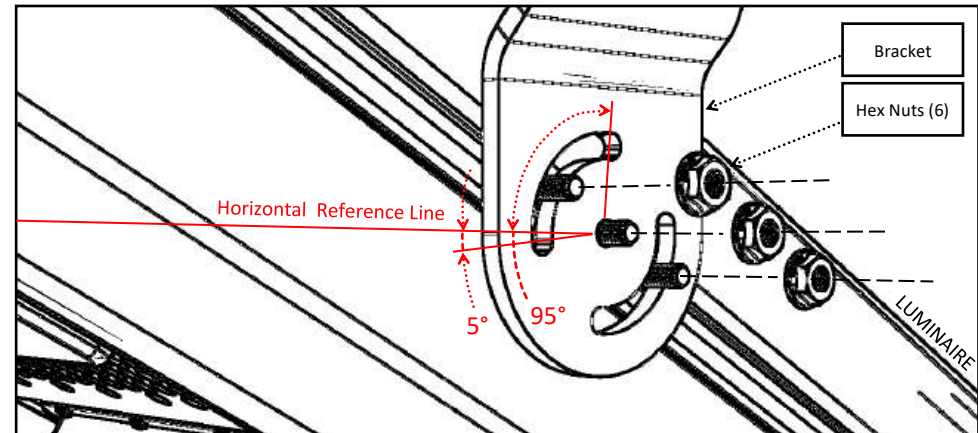

Support the fixture during all steps of the installation/orientation and follow all applicable installation codes.

Pole Mounting Installation

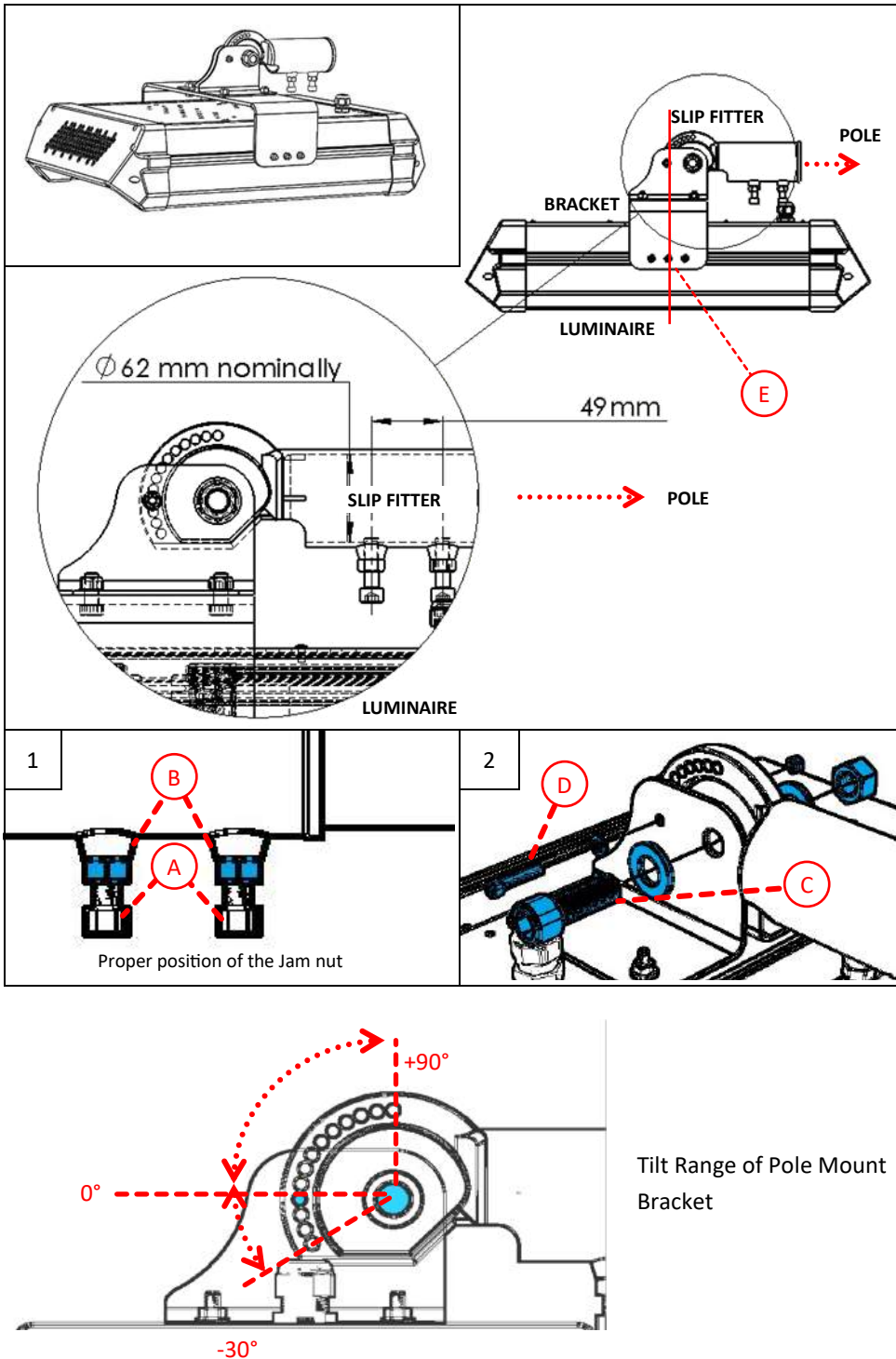

Proper installation:

Support the luminaire properly during installation.

1. The SLIPFITTER can adapt to a 60mm POLE. Seat the SLIPFITTER as far along the POLE, as possible. Both clamping bolts (see **point A**) must make firm contact with the round face of the POLE. 2x clamping bolts and 2x jam nuts are used to secure the SLIPFITTER.
 - i. With the SLIPFITTER fully seated onto the POLE, tighten both clamping bolts to fix the SLIPFITTER (see **point A**).
 - ii. Tighten both jam nuts (on the clamping bolts) against the SLIPFITTER (see **point B**).
2. **Orienting the Tilt of the Fixture:**

Use the appropriate aiming tools to orient and adjust the forward tilt of the LUMINAIRE.

 - i. Each M6 hole position in the pattern tilts the fixture by 10° . Maximum upward tilt is 90° . Maximum downward tilt is 30° .
 - ii. Attach the center M16 bolt (see **point C**) to the LUMINAIRE and SLIPFITTER and adjust for forward tilt.
 - iii. Attach the M6 set screw (see **point D**) to the LUMINAIRE to fix the tilt angle.
 - iv. Tighten all bolts to the appropriate torques.

LUMINAIRE should be positioned with the BRACKET close to center (see **point E**).

Safety cable may be installed with the fixture for additional installation security. Safety cable must be attached to the appropriate structure and slack must be removed from the safety cable for it to function properly.

Suspension Kit Installation

NEAR STRUCTURAL ELEMENT

1

1

2

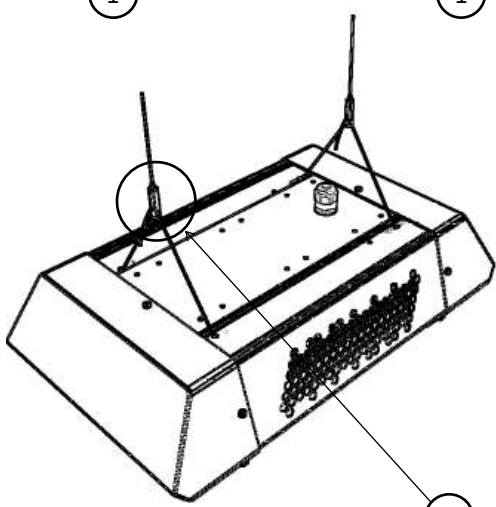

1

Loop around appropriate structural element.

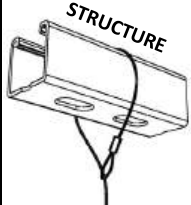

2

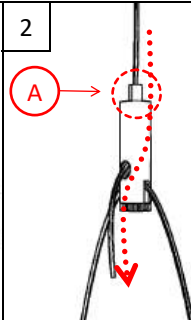

Supplied Hardware:

- Cable to loop around structure
- Gripper Assembly, pre-assembled to luminaire

Slide the Cable through the top of the Gripper Assembly. Gripper allows cable to move in one direction only.

To slide cable in opposite direction, hold down the top of Gripper (see point A). Once adjustment is complete, release the top of the Gripper. The Gripper will secure then secure the Cable from slipping out.

Tie up and secure the excess cable.

Part of the suspension kit is assembled into the luminaire. However, if for some reason the suspension kit not completely assembled into the fixture. Follow the following procedure to reattach the cable into the luminaire.

Please, do not disassemble the cable gripper assembly. Critical components may dislodge from their normal position and may cause the gripper assembly to be faulty.

For all other issues regarding installation of the suspension kit, please contact Lumigan Technologies.

1

Top of Fixture

Ø6.4mm Hole

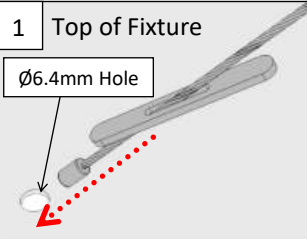

2

Top of Fixture

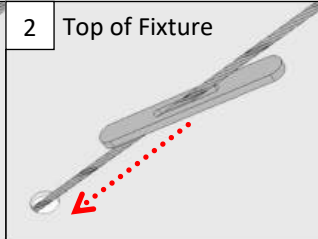

3

Inside of Fixture

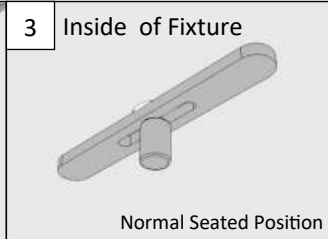

Normal Seated Position